



OWAtecta®



## System S 22 concealed, swing-down

Suitable for use in  
rooms with negative  
or positive pressure

Suitable for Clean Rooms

# System S 22

## concealed, swing-down

### Technical data

#### Standard module sizes:

600 mm x 600 mm  
625 mm x 625 mm

#### Material thickness:

galvanized Steel  
approx. 0.6 mm

#### Reaction to Fire (EN13501-1):

depending on product type  
A1 or A2-s2,d0  
according to EN 13501-1

#### Standard edge details:

Long edges bevelled O1  
Short edges bevelled O1

#### Suspension System:

All metal components are galvanized  
and/or painted

#### Minimum suspension depth:

Suspended approx. 270 – 280 mm

#### Cross section:

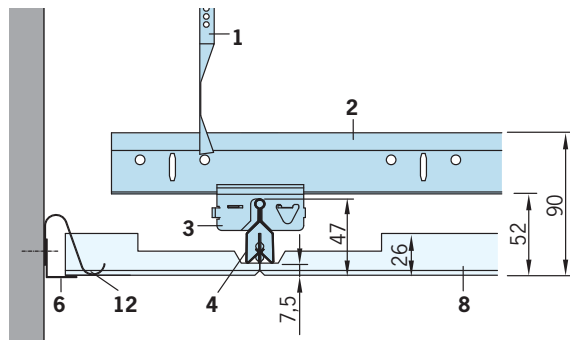

- 1 Nonius lower section No. 17/45
- 2 Main tee No. 45  
o/c distance  $\leq 1250$  mm
- 3 Cross connectors No. 93C
- 4 Clip-in profile No. 87B
- 5 Clip-in profile splice No. 88E
- 6 Wall trim No. 50 G
- 7 Wall spring No. 5220
- 8 Metal tile
- 9 Removal tool No. 99005
- 10 Stepped F-trim No. 5620F
- 11 Wall trim No. 50F
- 12 Wall spring No. 99009

#### Perforations:

##### Rd1522

1.5 mm hole diameter  
22 % open area

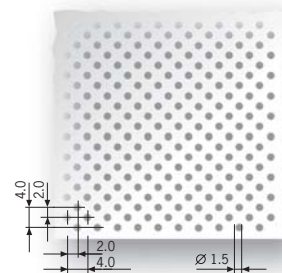

$a_w = 0.70$  NRC = 0.70

##### Rg2516

2.5 mm hole diameter  
16 % open area

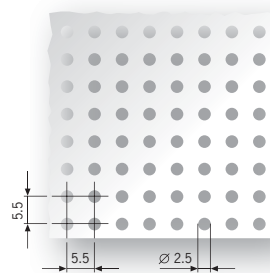

$a_w = 0.80$  NRC = 0.75

##### unperforated





# System S 22

## concealed, swing-down



### Perimeter Options:

Where used in small or narrow areas the ceiling layout should include at least one full tile to allow installation and or removal of retaining clips and perimeter tiles.

For more perimeter options please refer to OWAtecta® Installation Guide No. 303 E.

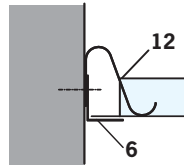

Wall trim  
**No. 50 G**, steel,  
white painted

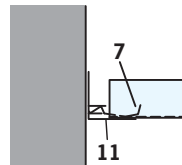

F-trim  
**No. 50F**, aluminium,  
white painted

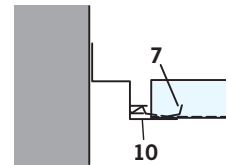

Stepped F-trim  
**No. 5620F**, aluminium,  
white painted

### Light fittings:

Compatible light fittings are available from OWA (see below).

Type: OWA-Lex  
OWA-Terra  
OWA-Opta

Dimensions: 600 mm x 600 mm  
625 mm x 625 mm

For more information please see leaflet No. 630.

**In clinical and  
hygienically  
sensitive areas**  
use non-perforated  
surface (LO)



**Can be used  
in Clean Rooms**



**Fraunhofer  
TESTED®  
DEVICE**  
Check Guide  
OWAtecta System S 22/23 31  
Report No. CW 1003-318

Please refer to OWAtecta Installation Guide No. 303 E for recommendations regarding additional loads on the ceiling (recessed lights, overlays etc) and the use of OWAtecta ceilings in adverse environmental conditions. Where any level of performance (fire, acoustics etc.) is required the ceiling must be installed in accordance with the relevant test report.

A guide to the components and quantities required for each system can be found in leaflet No. 300.



# System S 22 concealed, swing-down

### Positive / negative pressure environments (EN 12207: 2000-06)

OWAtecta system S22 and OWA-OPal recessed light fittings have been tested together as a complete ceiling system for air tightness by the Fraunhofer IPA, Stuttgart . The ceiling system was tested with a positive pressure of +80 Pa, a negative pressure of -50 Pa and achieved a Class 4 performance in accordance with EN12207: 2000-06

N.B. All tile and perimeter joints were sealed with a silicone sealant.

### Clean room Ceilings (EN ISO 14644-1)

OWAtecta system S22 and OWA-OPal recessed light fittings have been tested together as a complete ceiling system for use in clean rooms by the Fraunhofer IPA, Stuttgart. The result was a Class 1 performance in accordance with EN ISO 14644-1, demonstrating that special light units are not always required.

N.B. All perimeter trims and perimeter tiles were sealed with a silicone sealant.

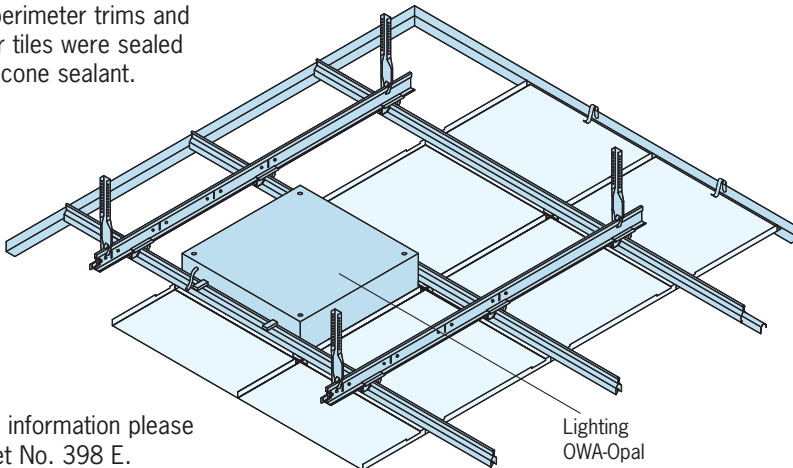

For more information please see leaflet No. 398 E.

Lighting  
OWA-Opal

### Lighting

Type	Description	Module size	IP Rating
8110/2 E	OWA-Opal	625 x 625	IP 54
8116/1 E	OWA-Opal	600 x 600	IP 54



### Quality Standards:

OWAtecta® metal tiles are manufactured from galvanised steel or aluminium and are available in non-perforated (Plain LO) or perforated options. With the exception of OWA Perfora, perforated tiles are supplied with a black acoustic fleece. Visible surfaces are powder coated white as standard, other colours are available on request. OWAAtecta® metal tiles, panels and planks are produced in accordance with TAIM guidelines (Technical Association of Industrial Metal Ceiling Manufacturers e.V).

### Product Warranties

The information provided in this leaflet is based on the standards and data available at the time of publication. Any performance, warranties or guarantees provided, express or implied, are subject to the exclusive use of OWA components and the installation of those components in accordance with our recommendations. Failure to adhere to these conditions will result in the invalidation of any performance claims, warranties or guarantees and rejection of any liability. OWA reserves the right to make any technical improvements in the products, systems or services without prior notice. All goods and services are supplied in accordance with our current Terms and Conditions of Sale.



**Odenwald Faserplattenwerk GmbH**  
 Dr.-F.-A.-Freundt-Straße 3  
 63916 Amorbach  
 Telefon: +49 9373 2 01-0  
 Telefax: +49 9373 2 01-1 30  
 www.owa.de · E-Mail: info@owa.de